

LVT ADHESIVE SHEETS

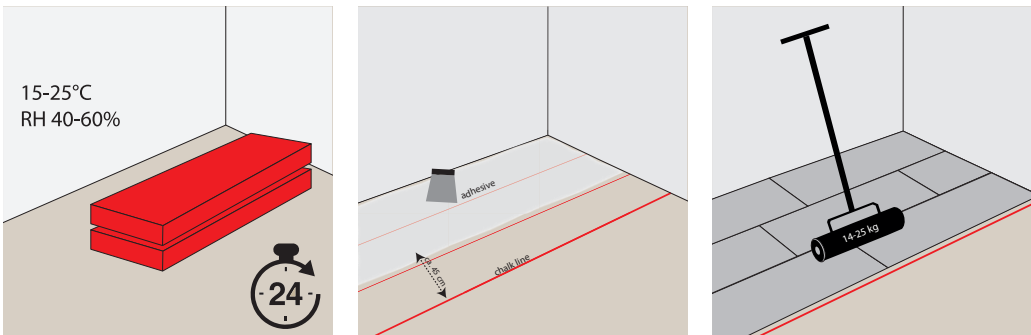

BEFORE INSTALLATION

When gluing the LVT-adhesive tiles, care should be taken to bond to a clean, dry, even and tensile and pressure-resistant and crack-free surface. The laying is suitable for cement screeds, anhydrite / flow coating, hot asphalt / mastic asphalt screed and dry screed installation panels. Substrates and/or subfloors with adhesive residues must be sanded off and cleaned.

The substrate must be primed with a suitable precoat concentrate, after drying with a more suitable leveling compound, a layer thickness of min. 2 mm to be compensated.

The maximum permissible unevenness of the subfloor must not exceed 2 mm to 1 m length (according to DIN 18202 line 4). The residual moisture content must not exceed 2.0 CM-% (anhydrite / floating screed 0.5 CM-%), 1.8 CM-% for anhydrous underfloor heating (anhydrite / floating screed 1.8 CM-%).

Dry screed / installation panels, bumps in the joint area must be sanded off and, if necessary, filled. If the laying plates are laid floating, they should be glued together firmly in the joint area and have a thickness of 20 mm.

Cork adhesive tiles should be acclimatized before installation at a room temperature of 15-25° C and a relative humidity of approx. 40-60%, 24 hours in a closed, surface-mounted package. Please also

note that the underground at the time of laying must have a temperature of at least 15° C.

Cork adhesive tiles can also be installed on underfloor heating, with a maximum surface temperature of 28° C.

The adhesive sheets should be checked in day-light for their perfect condition, any transport and material damage must be complained before laying. Differences in color and structure are material-related and therefore no reason for complaint. Adhesive variants are released for installation in damp rooms and wet rooms.

INSTALLATION

For the first row, a landing line is drawn on the ground with the help of a slat or a chalk line. This line should be recorded at a distance of three rows from the wall. Then, only cover this section of approx. 69 cm (from the line to the wall) with a suitable notched trowel and with a suitable fiber-reinforced wet adhesive for LVT adhesive tiles (e.g. Uzin KE66). Follow the instructions of your adhesive supplier. The surface must be fully covered with adhesive and the boards should be pressed strongly onto it. Before the adhesive binds, the plates should be rolled flat with a follower roller (weight 14-25 kg). A bottoming knife or cutter knife can be used to cut the plates. Scrape the plates from above with the knife and break them at the interface.

CLEANING AND CARE

The life of your floor depends on its use, cleaning and care. As a first care for LVT-adhesive tiles, a basic protection must be applied thinly and evenly. Depending on the load, regular maintenance care should be carried out. Use suitable cleaning agents for regular cleaning. We recommend to use a doormat or dirt carpet in the entrance area. The floor is protected by the use of felt glides on table and chair legs.

NOTE: It is possible to apply a refinish to the surface immediately after installation, or even years later.